



REEDY CREEK AND TYAAK

COMMUNITY EMERGENCY MANAGEMENT PLAN



Plan Approved: May 2024
Revision date: As required



Acknowledgement of country

Mitchell Shire Council acknowledges the Taungurung and Wurundjeri Woi Wurrung people as the traditional owners of the lands and waterways in the area now known as Mitchell Shire.

We pay our respect to their rich cultures and to elders, past, present and emerging, and other First Nations people who live, work and play in the area.

Traditional Owners

The Taungurung and Wurundjeri Woi Wurrung people are the traditional owners of the lands and waterways in the area now known as Mitchell Shire. There is also a large Aboriginal community which comprises of members from nations and clans across Australia.

We recognise the composition of Aboriginal communities in Mitchell is multifaceted. The delivery of self determination must encompass more than speaking with one group and requires consulting with different groups. True self determination within municipal boundaries ensures all cohorts in the community are represented with equitable voice, and that decision which effect Aboriginal and Torres Strait Islander communities in Mitchell are explored and undertaken in partnership with local Aboriginal communities.

On average a higher proportion of Aboriginal and Torres Strait Islander families and communities call Mitchell home than other parts of Melbourne and Victoria.

(Mitchell: 1.6%, Greater Melbourne: 0.5%, and Victoria: 0.8%, - Profile ID)



**Supporting the
local community
to become
safer and more
resilient**



Kilmore East fire from Mt Hickey

©copyright Phil Searle 07/02/09 @ 11.59am

COMMUNITY EMERGENCY MANAGEMENT PLAN

Contents

1. Overview	Page 6
1.1 Introduction	Page 6
1.2 Aim	Page 6
2. Reedy Creek and Tyaak Overview	Page 7
3. Reedy Creek and Tyaak Risks in an Emergency	Page 8
4. Reedy Creek and Tyaak Residents understanding of Emergency Risks	Page 9
5. Preparedness	Page 11
5.1 What are you going to do?	Page 12
5.2 Make an Emergency Plan	Page 13
5.3 Back Up Information	Page 13
5.4 Prepare a Kit	Page 14
5.5 Stay Informed	Page 15
6. Fire Danger	Page 17
Fire Danger Rating System	Page 17
Tips on Preparing your Property	Page 18
7. During an Emergency	Page 20
Community Evacuation Information	Page 21
8. Recovery	Page 22
Appendix 1	Page 23
Tyaak and Reedy Creek Map	
Appendix 2	Page 24
When to Open the Community Emergency Hub	

Overview

1.1 Introduction

The Reedy Creek and Tyaak Community Emergency Management Plan has been developed by the Reedy Creek and Tyaak Working Group on behalf of the local community. As such, the Reedy Creek Working Group acknowledges all who have participated and contributed toward the development of this plan.

This document is managed and distributed by the Reedy Creek and Tyaak Working Group. This plan is reviewed and amended as required.

While every effort has been made to ensure that information in this document is correct at the time of printing, changes after the time of publication may impact on the accuracy of the information.

The working group is not responsible for any loss suffered in connection with the use of document and should be read in conjunction with the Mitchell Shire Emergency Management Plan.

1.2 Aim

The aim of this plan is to assist the Reedy Creek and Tyaak Community to prepare for and respond to emergencies, extreme weather events and other disasters.

We plan to do this by identifying:

- *Local stressors and emergency risks*
- *Local knowledge to create a safer community and become more resilient*
- *Collaborating with emergency services and other agencies*



2.

Reedy Creek and Tyaak

Overview

The township of Reedy Creek is situated within the Mitchell Shire and lies 99kms north of Melbourne at 358 metres elevation. It is approximately 15 minutes to the nearest main town of Broadford. The Reedy Creek population as of 2021 is 157 with a total of 89 dwellings. Tyaak has a population of 85 with a total of 27 dwellings.

Reedy Creek township abuts Mount Disappointment which is dense bushland. Tyaak abuts the Tallarook State Forest.

Reedy Creek was established in 1861 for gold mining purposes, with housing, a school, pubs, and other buildings being built. The town was named for the creek that runs around it and under the bridge at the town's entrance. The creek is only filled by large rainfalls, and for most of the year it is dry. The town is surrounded by bushland, and is in a valley. The roads to the area see a high population of walkers, hikers, campers, trail bike riders and four wheel drivers all year round.

Reedy Creek extends to Murchison Spur Road and Horans Track to the east and some way to the west including Cunninghams Road/English Road. The area has a substantial fire history including the 2009 Black Saturday fires. According to the Victorian Fire Risk Register the area's fire danger rating is extreme which relates to land use, vegetation, slope, wind and rainfall.

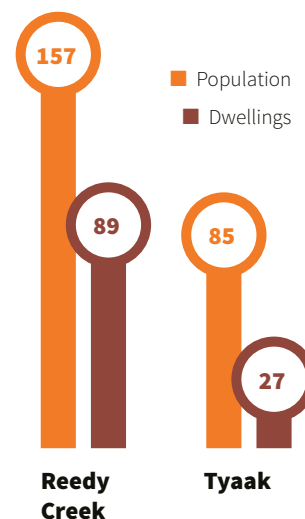

3.

Reedy Creek and Tyaak

Risks in an Emergency



Bushfire Risk

- *The Reedy Creek and Tyaak area Victorian Fire Risk Register Rating is extreme therefore the likelihood of fire threatening people and is always present*



Flooding/Storm

- *After heavy rains, Dabyminga Creek can experience flooding*
- *Risk of trees falling causing injury by hitting people, homes or vehicles*
- *Road access restricted due to fallen trees or flooding*
- *Flooding*
- *Increase in vehicle accidents on local roads and Hume Freeway*



Transport Incidents

- *In the event of a transport incident in Reedy Creek and Tyaak, roads may be closed.*
- *Road access may be affected - including hazards caused by Chemical spills or release of chemical gas*



Extreme Weather and Heat

- *Extreme heat may affect both people and animals*
- *With extreme heat people also have increased anxiety due to the risk of fire in the area*



Power outages can occur during an emergency and what to do

- *Expect and plan for disruption.*
- *Have a back-up plan ready if you rely on life support equipment or need electrical items to care for babies, the disabled, elderly or pets*
- *Plan to keep food safe. Set your fridge to 5 degrees (5°C) or below. An unopened fridge will keep food for about four hours*
- *Have plenty of drinking water available if your supply relies on power*
- *Consider alternatives to running water pumps if on tank water*
- *Charge mobile phones, laptops and portable back-up batteries*
- *If you have a rooftop solar system or a battery, check that it is able to operate in a power outage*
- *If you plan to use a diesel generator, make sure it's fully fuelled, operational and that you know how to safely operate it*
- *Have a battery-powered radio available for real time news updates*
- *Keep battery-powered lamps or torches handy*

4.

Reedy Creek and Tyaak

Residents understanding of Emergency Risks

Community Information

A Survey of residents in 2022 identified:

68% of residents have a personal emergency plan in place but don't practice it and 16% don't have a personal emergency plan at all

58% of residents don't consider other emergency events other than fire

Vulnerabilities in the Community:

- *Limited landline, mobile phone and internet coverage*
- *Communications fail with power failures during emergencies. Transmission towers and telephone exchanges can fail during emergencies*
- *Distance from main town services (e.g. Bradford)*
- *If roads are impassable due to fire or flood, late evacuees will be trapped in a dangerous situation*
- *Water and Fuel may not be accessible*
- *Restricted access and egress will result in limited ability to evacuate in certain circumstances*
- *Emergency evacuation and decisions based on assets and/or pets rather than acknowledging the immediate threat to life*

Isolation

The township of Reedy Creek has only one viable road for access/egress in an emergency event (Reedy Creek Road). There are a number of similar 'dead end' roads in Reedy Creek and Tyaak (e.g. English Road, Cunninghams Road).



Have you made a plan?

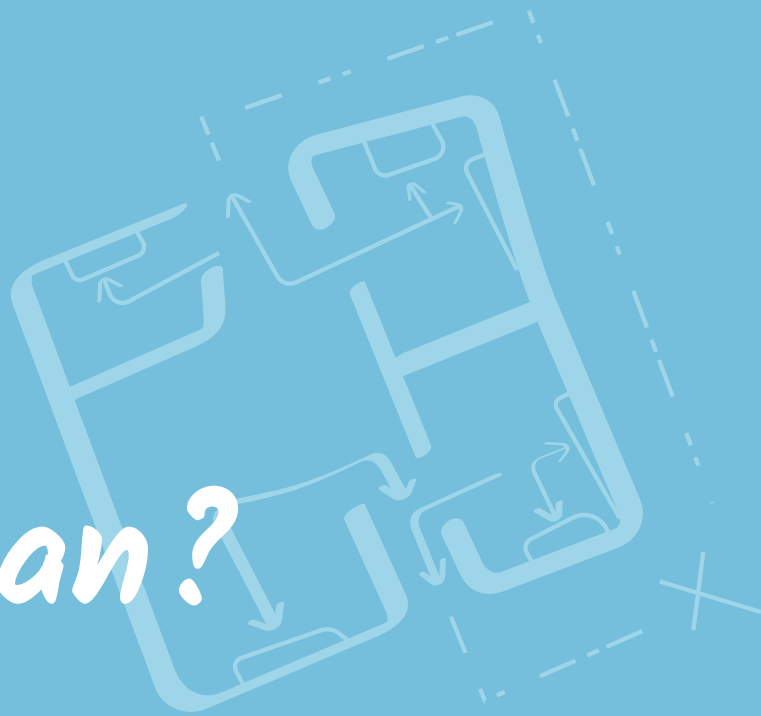

Decide what each family member will do during an emergency event

Talk with your family about emergencies most likely to occur where you live and how you will respond

Practice the steps of your plan as much as possible

Community members can contact their local brigade to find out community programs such as:

- *Home Fire Safety*
- *Fire Planning Workshops*
- *Community Fire Guard*

Contact your local Brigade or District Office to see if this service is delivered in your area:

<https://www.cfa.vic.gov.au/about-us/cfa-events>



5.

Preparedness



5.1

What are you going to do?



You can handle any emergency better if you are prepared!

Whatever the emergency



Expect the unexpected

Emergencies can be hard to predict and emergency services may be unable to reach you in a disaster.

What will you do for the first 72 hours if you have no services such as:



NO POWER



NO WATER



NO GAS



NO RECEPTION



NO ROAD ACCESS



LIMITED FOOD

5.2 Make an Emergency Plan

WHO ...

do I need to consider?
do I need to tell?

WHAT ...

do I need to know?
do I need to do?

WHERE ...

will I go?
do I get information?
do I keep my plan?

HOW ...

will I get there?
will I get there – plan B?

WHY ...

do I need to make a plan?

5.3 Back up Information

IMPORTANT THINGS TO SAVE:

- Your emergency plan
- Identification (to prove who you are)

DOCUMENTS

- Insurance policies
- Property documents
- Medical information and prescriptions
- Financial records

HOME INVENTORY

- Photos of possessions
- Photos of house assets
- Receipts, warranties etc.

CONTACT LIST

- Family
- Utility providers
- Other:



To prepare for fire:
cfa.vic.gov.au



To prepare for flood and storm:
ses.vic.gov.au



Set up a watch zone:
emergency.vic.gov.au



Rediplan:
redcross.org.au/prepare

TO SUPPORT PLANNING



Pets and Emergencies:

agriculture.vic.gov.au/livestock-and-animals/animal-welfare-victoria/pets-and-emergencies/planning-for-pets-in-emergencies



Resilient
Building
Council



Bushfire Resilience Rating Home-
Assessment:
rating.rbcouncil.org

5.4 Prepare a Kit

Gather and store items ready to support you and your family for 72 hours

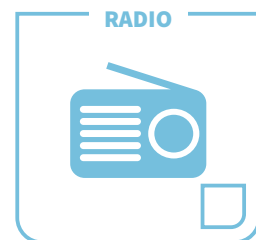
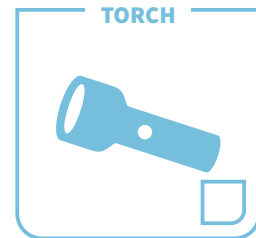
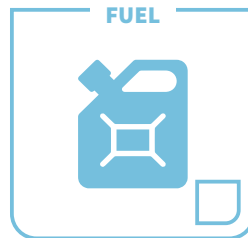
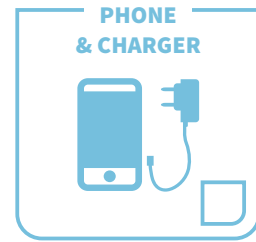

EMERGENCY PREPARATION STARTS WITH YOU!

Emergency management is a shared responsibility between individuals, communities, Council and agencies. Preparation is key to reducing impacts and to supporting emergency services. Emergency services will have high demand in an emergency event. As a part of your emergency plan, households should be prepared for up to 72 hours of isolation. Prepare a household emergency kit.

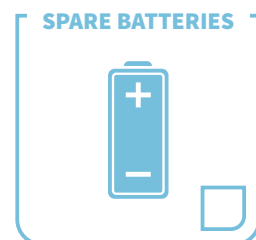

5.5 Stay Informed

Emergency Preparation starts with you.



AusNet - Gas and Electricity

www.outagetraacker.com.au



Australian Government

BOM Weather

www.bom.gov.au



CFA

www.cfa.vic.gov.au



Department of Health

[www.health.vic.gov.au/environmental-health/
climate-weather-and-public-health](http://www.health.vic.gov.au/environmental-health/climate-weather-and-public-health)



Goulburn Valley Water

www.gvwater.vic.gov.au



Mitchell Shire Council

www.mitchellshire.vic.gov.au



It is important to tune into official and accurate information channels to stay informed with the facts before, during and after an emergency.

Apps can be downloaded from (iTunes Store or Google Play Store)



Nurse on Call

www.healthdirect.gov.au/nurse-on-call

1300 60 60 24 (24/7)



Emergency Radio Broadcast

ABC Radio 774 AM

Listen online, on the ABC listen app, on channel 25 on your television, via DAB+ Digital Radio or On Air Connect to UHF Radio Channel 14



St Johns Ambulance

www.stjohnvic.com.au



Vic Emergency

emergency.vic.gov.au / 1800 226 226 (Press 9 for interpreter)

Set up a Watch Zone for the area you live or are located in

support.emergency.vic.gov.au/hc/en-gb/articles/235478427-How-do-I-create-a-watch-zone-



Vic SES

www.ses.vic.gov.au

132 500



VicTraffic

traffic.vicroads.vic.gov.au



6.

Fire Danger Rating System

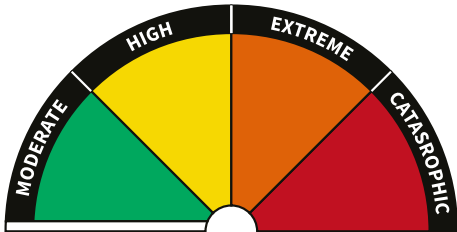

Fire Danger Ratings tell you how dangerous a fire could be if one started. The higher the rating the more dangerous the conditions. Fire Danger Ratings feature in weather forecasts during the fire season.

To check your district's daily Fire Danger Rating, visit cfa.vic.gov.au or call **1800 226 226**.

	WHAT DOES IT MEAN?	WHAT SHOULD I DO?
CATASTROPHIC	<p>If a fire starts and takes hold, lives are likely to be lost.</p> <ul style="list-style-type: none"> ▶ These are the most dangerous conditions for a fire. 	<p>For your survival, leave bushfire risk areas.</p> <ul style="list-style-type: none"> ▶ Your life may depend on the decisions you make, even before there is a fire. ▶ For your survival, do not be in bushfire risk areas. ▶ Stay safe by going to a safer location early in the morning or the night before. ▶ Homes cannot withstand fires in these conditions. You may not be able to leave and help may not be available.
EXTREME	<p>Fires will spread quickly and be extremely dangerous.</p> <ul style="list-style-type: none"> ▶ These are dangerous fire conditions. ▶ Expect hot, dry and windy conditions. 	<p>Take action now to protect your life and property.</p> <ul style="list-style-type: none"> ▶ Check your bushfire plan and that your property is fire ready. ▶ If a fire starts, take immediate action. If you and your property are not prepared to the highest level, go to a safer location well before the fire impacts. ▶ Reconsider travel through bushfire risk areas. ▶ Leaving bushfire risk areas early in the day is your safest option.
HIGH	<p>Fires can be dangerous.</p>	<p>Be ready to act.</p> <ul style="list-style-type: none"> ▶ There's a heightened risk. Be alert for fires in your area. ▶ Decide what you will do if a fire starts. ▶ If a fire starts, your life and property may be at risk. The safest option is to avoid bushfire risk areas.
MODERATE	<p>Most fires can be controlled.</p>	<p>Plan and prepare.</p> <ul style="list-style-type: none"> ▶ Stay up to date and be ready to act if there is a fire.

Monitor conditions and official sources for warnings by going to cfa.vic.gov.au, emergency.vic.gov.au or call the VicEmergency Hotline on **1800 226 226**



FOR RURAL AND SEMI-RURAL ALLOTMENTS

Reduce fuel for at least 20 metres around dwellings, your boundary fence and neighbours' assets

Make sure your stock are safe - build a fire safe area or paddock by creating a mineral earth break and reducing fuel loads

Create a firebreak of 10 metres around the perimeter of any allotment boundary that adjoins a township

Defending your property: For information before a fire the information is located:
<https://www.cfa.vic.gov.au/plan-prepare/before-and-during-a-fire/defending-your-property>

Leaving early – what does it mean?

‘Leaving early’ means being away from high-risk fire areas before there are any signs of fire. It does not mean waiting for a warning or a siren. It does not mean waiting to see or smell smoke. And it certainly does not mean waiting for a knock on the door.



10 important decisions to make with your family before summer

- Which Fire Danger Rating is your trigger to leave?
- Will you leave early that morning or the night before?
- Where will you go? What will you take with you?
- What route will you take and what is your back up route if a fire is already in the area?
- What are you going to do with your pets or livestock?
- Who else do you need to talk to about where you are going?
- What will you do if all members of your household are not home?
- How will you stay informed about warnings and updates?
- What will you do if there is a fire in the area and you cannot leave?
- What will you do if your household is not together when your trigger is reached?

When you decide to leave is the most important decision you will make.

Driving in a bushfire is extremely dangerous and can be fatal. A drive that would normally take five minutes could take two hours with road closures, traffic jams, crashes, smoke, fallen trees and embers getting in the way.

Plan ahead so you know how you will leave. Know different routes to get out of the area – some may be closed if a fire is already burning nearby.

It's up to you to decide where you will go on a fire risk day. Don't wait and see.

Fires can start and spread very quickly.

Leaving early is the safest option for anyone in a high risk bushfire area. Many people have died trying to leave at the last minute.

If you care for children, older people or those with a disability you must leave early.

7.

During an Emergency

Life Threatening Emergencies:

Fire, Ambulance, Police



📞 000

For 24/7 Crisis support call **Lifeline** or **Beyond Blue**



📞 13 11 14



📞 1300 22 4636

Warnings and Updates



Emergencies can be overwhelming

- *There is no Neighbourhood Safer Place - Bushfire Place of Resort in Reedy Creek or Tyaak Always leave early prior to a Catastrophic Fire Danger Rating Day*
- *Make sure family members and neighbours are aware of what is happening*
- *Beware of driving hazards and wildlife*

It is important to get your information from official channels to ensure you have timely and accurate information before during and after an emergency

Make sure you monitor services identified under 5. Stay Informed.

COMMUNITY EVACUATION INFORMATION

Victoria Police is responsible for co-ordinating an evacuation, which will only be recommended if it can be done safely and there is an imminent threat to you.

How will I know when to evacuate?

In fast-moving emergencies you may not receive a warning or a recommendation to evacuate. If you do, you may receive an emergency warning from a number of sources. Such as:

- *Telephone emergency alert (fixed line and SMS)*
- *Emergency broadcasters (radio and television)*
- *Emergency service websites or apps*
- *Door knocking*
- *Police vehicle loudspeaker*

For more information, refer to the **Warnings & Alerts** information provided in this Guide.

The presence of police or other emergency services during an evacuation cannot always be guaranteed

What do I do when I am advised to evacuate?

Follow ALL directions and instructions from emergency services. If time permits. Secure your premises and collect any valuables. Including your emergency kit.

What do I do about my animals?

You need to pre-plan for pets and livestock in the event of an emergency. Leave early with your pet emergency kit

What if I require assistance to evacuate?

If you require assistance to evacuate take this into account as part of your planning. If you do not have transport to leave the area, have an alternative plan in place. Such as leaving with neighbours or arranging for family to help you.

Where should I go?

You should go to the safe location advised in the warning. Once you have evacuated to the safe location, such as an emergency relief centre, you may be required to register your personal information.

DO NOT RETURN UNTIL YOU ARE ADVISED THAT IT IS SAFE TO DO SO.

8.

Recovery

Recovery Planning and Local Arrangements

Follow advice from the Vic Emergency App or website, media channels and authorities. Check with Mitchell Shire Council in the first instance for Recovery Centre arrangements. Mental Health support may be available at a Council recovery centre.

Depending on the type of emergency and local circumstances, the need for the community to support itself, the Clonbinane Community Hall may be used in the recovery phase. *(See Appendix 3 for When to open a Community Emergency Hub. This appendix is also located in the Community Emergency Hub Kit).*

Donations

Please wait to make any donations until as directed. Local donation opportunities will be communicated to the community, around specific requirements or where money can be given, via facebook.

Animal Management

Owners are responsible for management of their pets and livestock. However options for emergency agistment may be developed as part of the community response.

- **For wildlife emergencies contact Wildlife Victoria**

1300 094 535

- **Help for Wildlife**

0417 380 687

or;

- **Wildlife Rescuers**

0417 506 941

If an animal is suffering and needs to be euthanised, you can also call the local police or a nearby Vet.

APPENDIX 1

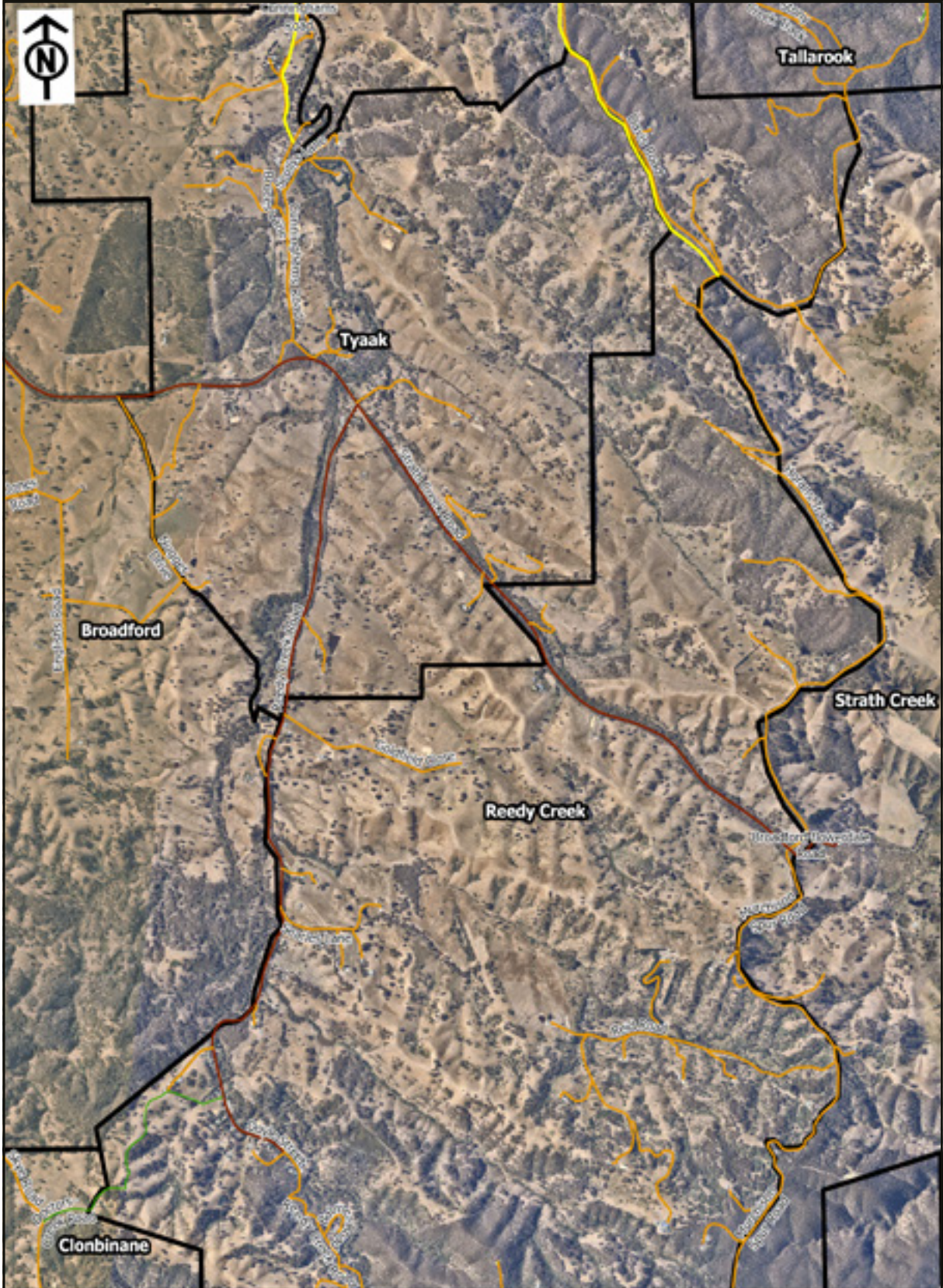

Legend	
— Highway, Freeway	— Trail
— Arterial, Sub-Arterial	— Fire Tracks
— Collectic, Local, Minor	 Locality
— Major Track, Minor Track	

Tyaak and Reedy Creek Map



Scale: 1:30,000

Spatial Reference
 Name: GDA2020 MGA Zone 55

Disclaimer: This map product has been produced by Mitchell Shire Council. While all efforts have been taken to ensure the accuracy of this product, there may be errors and/or omissions in the data presented. Users of this product are advised to independently verify data for accuracy and completeness prior to use.

Map prepared by: Shema Tomlinson
 Map date: 30/11/2023



When to open the Community Emergency Hub

The first 72 hours after a disaster can be chaotic, confusing and very stressful. Community Emergency Hubs can be opened by residents when townships are isolated because of the impact of a large scale emergency. There may be widespread infrastructure damage to buildings and roads and communication networks may be down for extended periods.

Objectives of the Community Emergency Hub are to:

- Provide information so your community knows how to help each other and stay safe.
- Understand what is happening.
- Solve problems using what your community has available
- Provide a safe gathering place for members of the community to support one another.

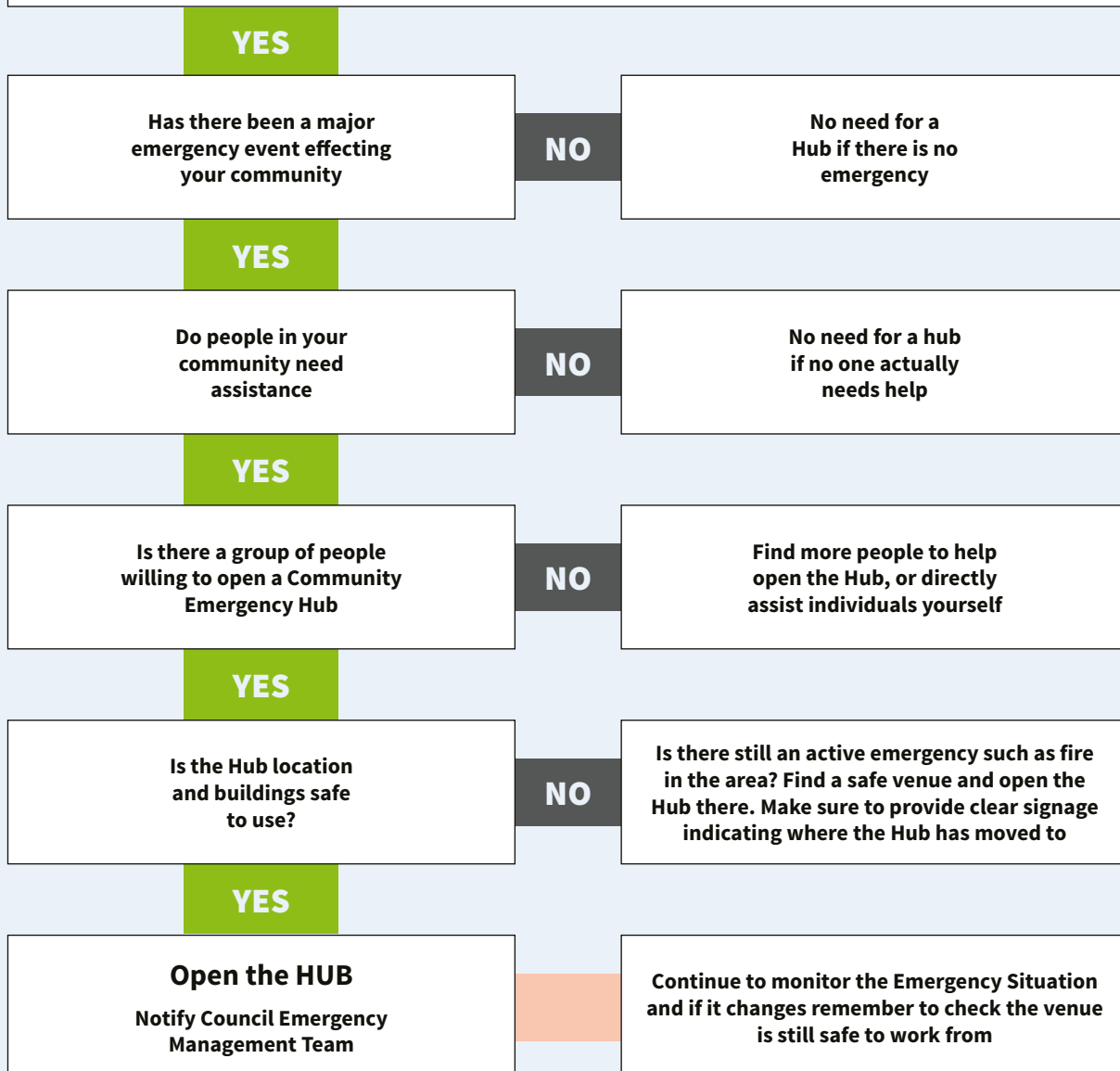

Step 1 – Before Accessing and opening the Hub

- Check the Facility is Safe outside and that the threat of the emergency has passed – If not, find another location and leave a note on building to say where you are relocating to
- Check for potential hazards – flooding or slips, fires nearby, exposed wires, smell of gas or sewerage
- Notify Council Emergency Management Team and ask to speak to the Municipal Emergency Management Officer on 5734 6200
- If you have the keys to the facility you can open up the Hub. Other people in the community may also have keys or other ways to access the Hub, such as the building owner

Step 2 - Once Hub is open

- Locate the Community Emergency Hub Kit
- Activate Satellite internet and generator and radio/torch (if applicable)
- Find Emergency Hub Kit. The inventory list of the Hub kit is located within the box
- Set up whiteboard for updates and assign a person to register who is attending/leaving the hub

Step 3 - Identify a safe space to work in

- The facility needs to be easily accessible – some people may be in wheelchairs, have buggies/pushchairs, or have limited mobility.
- Do not put yourself in unnecessary danger. Contact 000 if there is a life threatening situation
- The Hub may need to increase or decrease in size during the time it is open, depending on the community's needs.
- Continually evaluate the emergency situation through Emergency warnings

Step 4 - Clean Up and wrap down

- Tidy Up the rooms by cleaning up rubbish and broken items
- Lock the venue if a hall or venue indoors is used
- Stay in touch with Council for further information on closing

Never Forgotten

BLACK SATURDAY 7th February 2009

Reedy Creek Memorial

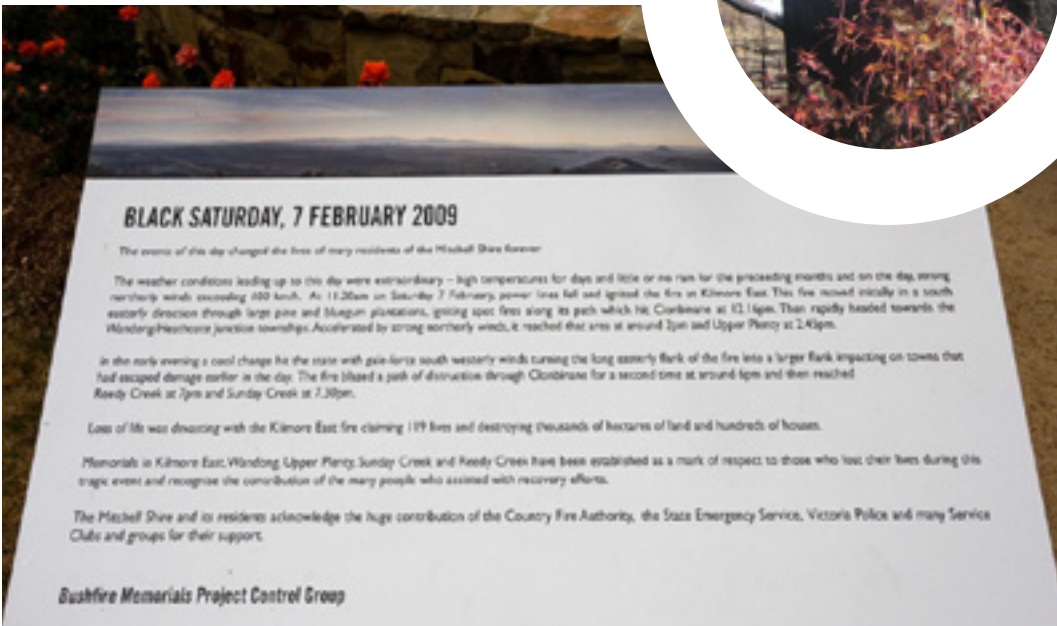

BLACK SATURDAY, 7 FEBRUARY 2009

The events of this day changed the lives of many residents of the Mitchell Shire forever.

The weather conditions leading up to this day were extraordinary – high temperatures for days and little or no rain for the preceding months and on the day strong northerly winds exceeding 100 km/h. At 11.20am on Saturday 7 February, power lines fell and ignited the fire in Kilmore East. The fire moved initially in a south easterly direction through large pine and Muehlenberg plantations, getting spot fires along its path which hit Corbinvale at 12.11pm. Then rapidly headed towards the Wandong/Heathcote junction townships. Accelerated by strong northerly winds, it reached that area at around 1pm and Upper Plenty at 2.40pm.

In the early evening a cool change hit the state with gale-force south westerly winds turning the long easterly flank of the fire into a larger flank impacting on towns that had escaped damage earlier in the day. The fire blazed a path of destruction through Clonbinane for a second time at around 6pm and then reached Reedy Creek at 7pm and Sundry Creek at 7.30pm.

Loss of life was devastating with the Kilmore East fire claiming 119 lives and destroying thousands of hectares of land and hundreds of houses.

Memorials in Kilmore East, Wandong, Upper Plenty, Sundry Creek and Reedy Creek have been established as a mark of respect to those who lost their lives during this tragic event and recognise the contribution of the many people who assisted with recovery efforts.

The Mitchell Shire and its residents acknowledge the huge contribution of the Country Fire Authority, the State Emergency Service, Victoria Police and many Service Clubs and groups for their support.

Bushfire Memorials Project Control Group

**SAFER
TOGETHER**